



Website: durhamsafecycling.ca
Email: info@durhamsafecycling.ca
Mail: 1B-701 Rossland Road East
Suite # 629
Whitby ON, L1N 9K3

Advocating for Safe Cycling Throughout Durham Region

Town of Whitby
Planning and Development Public Meeting
575 Rossland Road East
Whitby, ON
L1N 2M9

Via e-mail: clerk@whitby.ca

January 19, 2024

RE: DEV-28-23: Draft Plan of Subdivision Application (SW2023-04), Zoning By-law Amendment Application (Z10-23), Icon Taunton Limited, 945 Taunton Road East

Dear Members of Council,

We are Durham's leading safe cycling advocacy voice representing a wide-ranging demographic of cycling enthusiasts across the Region.

As such, Durham Region Cycling Coalition (DRCC) is pleased to have the opportunity to provide feedback relating to the above noted public meeting application scheduled for Monday, January 21, 2024.

Upon review of the pre-meeting report - and given the high volume of vehicle traffic anticipated with this proposal which fronts onto two major cycle corridors - we note the following:

- The Traffic Impact Study (page 5) is requesting a reduction in vehicle parking referencing the site adjacency to "public transit routes and connection to cycling and pedestrian routes" however, within the proposed development there is zero cycling infrastructure support - other than two unsecured bike parking locations - as an alternative means of transportation which is a big miss by the developer.

Further to this, as we reviewed Attachment # 4, there is no reference within the applications proposal as to having reviewed the Town of Whitby Active Transportation Plan and or recognized the current Active Transportation Infrastructure in place fronting the site on Taunton Rd and Garrard Rd.



Website: durhamsafecycling.ca
Email: info@durhamsafecycling.ca
Mail: 1B-701 Rossland Road East
Suite # 629
Whitby ON, L1N 9K3

Advocating for Safe Cycling Throughout Durham Region

As such our concerns include:

- Taunton Road
 - Recognizing the proposed entrance / exit to Taunton Road crosses a key **Active Transportation Multi Use Path (MUP)** versus the reference of an “Asphalt Path” what provision are being made regarding safety at this proposed crossing?
 - Will a “High Volume Cross Ride” be installed at this MUP supporting cycling safety?
 - Reference Attachment #1 - OTM Book 18
- Garrard Road
 - The proposed entrance / exit at Garrard crosses an **Urban Paved Shoulder Identified Bike Route**. (Reference Attachment # 2)
 - Will this newly created conflict zone be supported with on road high volume conflict zone markings?
 - Reference attachment #3 - OTM Book 18
 - In support of this request, Garrard Rd is identified within the Town of Whitby’s AT Plan as a primary cycle route with an imbedded on road cycle counter located approximately 75m south of this site with recent data indicating high sustainable cycle traffic. (Reference attachment #4)

Lastly, and in the interest of our road ways most vulnerable users, we would also request the applicant have in place preconstruction safety measures to ensure both on road and MUP cyclists will be fully protected during all phases of construction including the following;

- Install concrete jersey barriers along the MUP fronting Taunton Rd thus preventing construction traffic from using the MUP for site access, storage and passage way.
- Close site access from Garrard Rd. and Taunton Rd thereby restricting site access via Sebastian St. only which limits conflict zones.



Website: durhamsafecycling.ca
Email: info@durhamsafecycling.ca
Mail: 1B-701 Rossland Road East
Suite # 629
Whitby ON, L1N 9K3

Advocating for Safe Cycling Throughout Durham Region

In closing, we are very disappointed to see this application moving to an approval stage with no review of the Town of Whitby Active Transportation Plan given the location fronts two major heavily used cycle corridors.

As such, our recommendation would be for the Council to not approve this application until the issues raised are addressed in the form of a revised application.

On behalf of every-one at DRCC, thank you for taking time to consider our submission.

Respectfully,

Ron Lalonde

Executive Director
Durham Region Cycling Coalition
www.durhamsafecycling.ca

c.c. R. Saunders, Commissioner of Planning and Development

E. Roy, Mayor, Town of Whitby

Attachment # 1

OTM Book 18 Taunton Road MUP

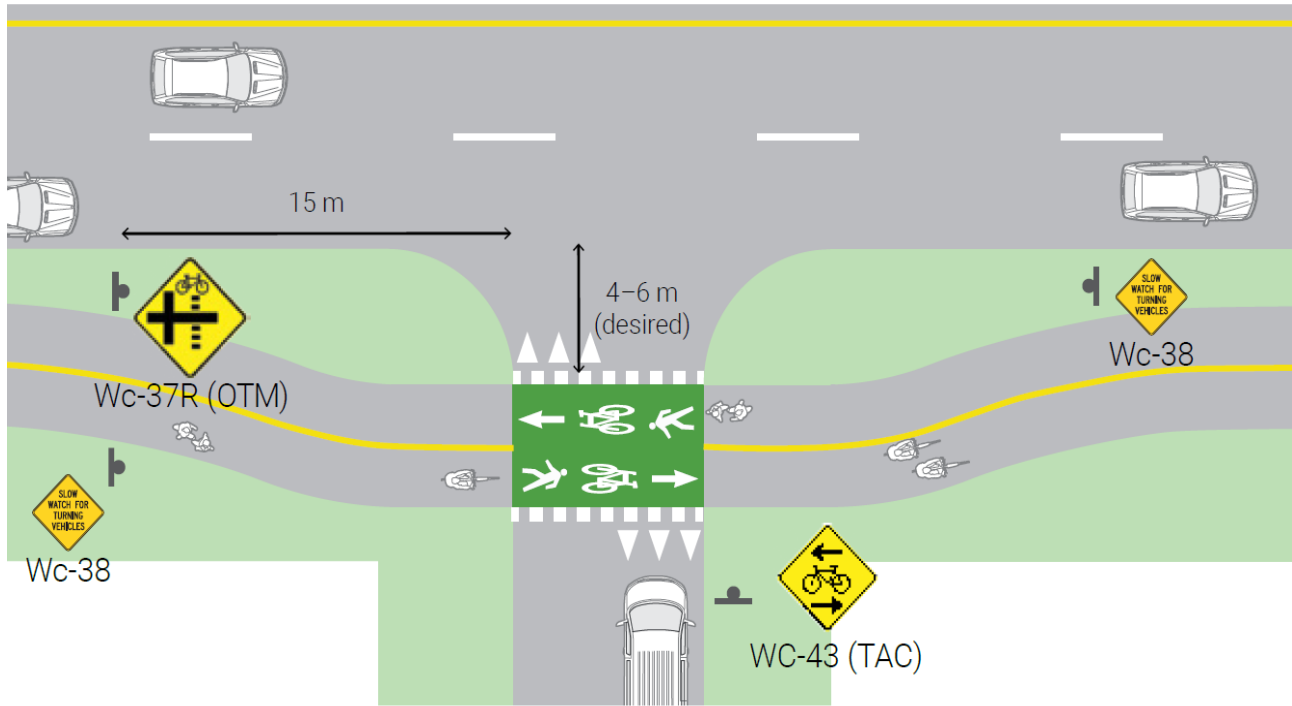

Figure 6.72 – High-Volume Driveway Treatment, In-Boulevard Facility (Multi-Use Path)



Website: durhamsafecycling.ca
Email: info@durhamsafecycling.ca
Mail: 1B-701 Rossland Road East
Suite # 629
Whitby ON, L1N 9K3

Advocating for Safe Cycling Throughout Durham Region

Attachment # 2

Garrard Road proposed site entrance



Attachment # 3

OTM Book 18 Garrard Road

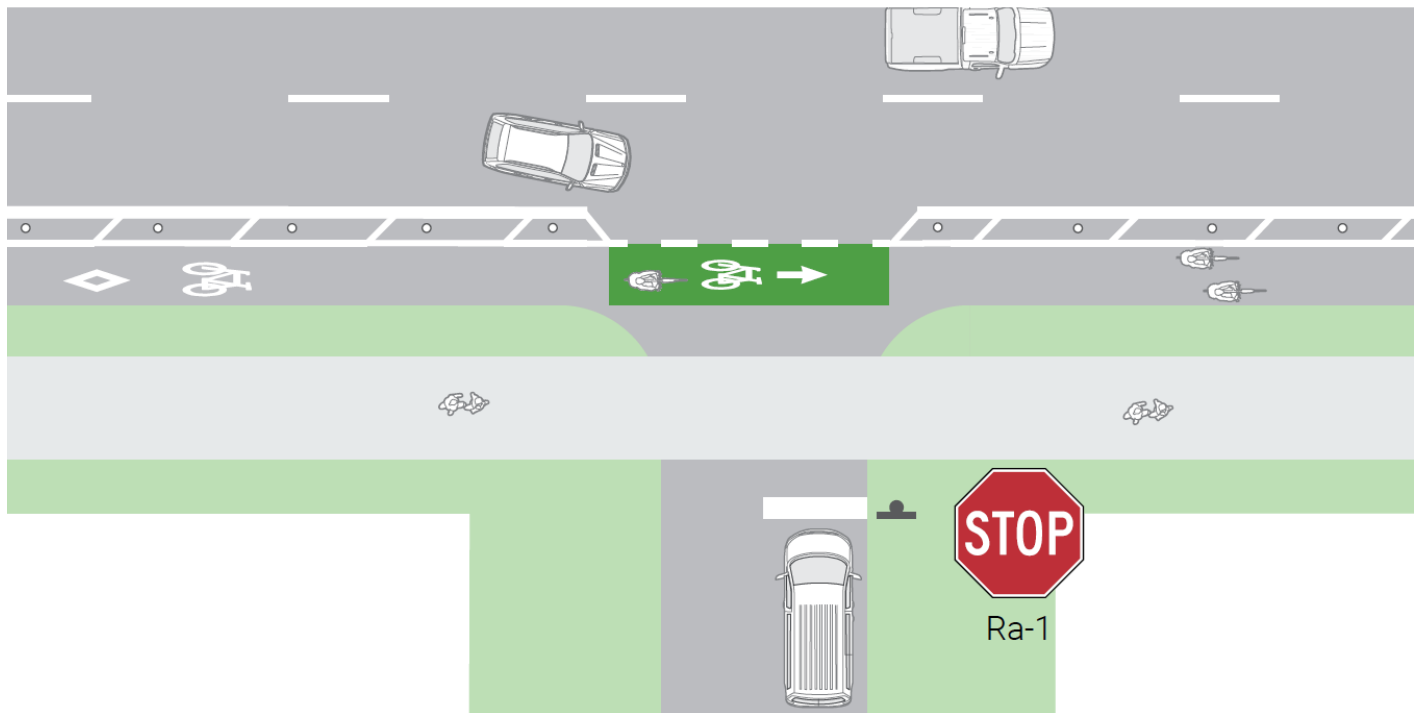

Figure 6.69 – High-Volume Driveway Treatment, On-road Facility



Website: durhamsafecycling.ca
Email: info@durhamsafecycling.ca
Mail: 1B-701 Rossland Road East
Suite # 629
Whitby ON, L1N 9K3

Advocating for Safe Cycling Throughout Durham Region

Attachment # 4

Eco Counter Bike Data*

Key Figures Summary [↗](#)

📅 10/03/2021 → 09/03/2022

Site	Daily Average	Peak Day	Peak Count
Garrard S of Taunton	130 ▲ 40.4%	Wed 8 Sep 2021 Tue 27 Oct 2020	247 ▲ 5.1%

*Source- Town of Whitby